

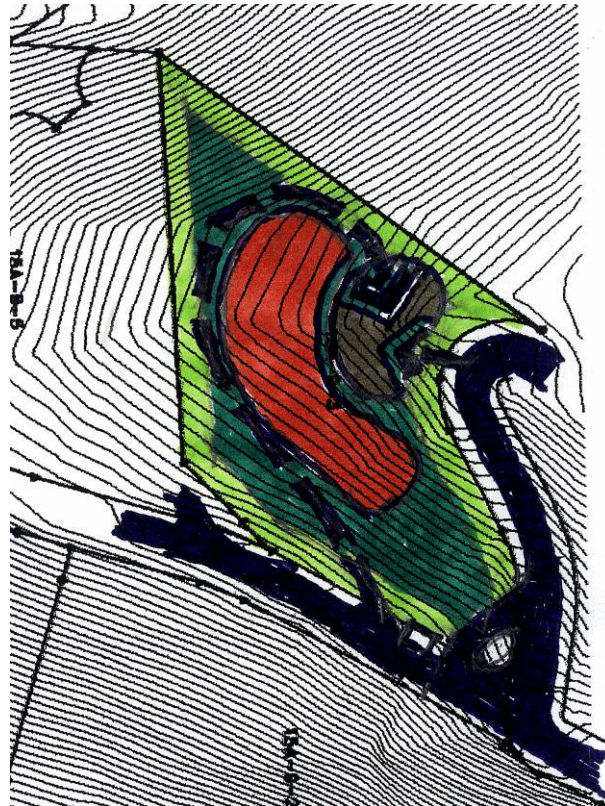







# Ditleff Point

Rendezvous Bay, St. John, United States Virgin Island

## Lot 15A-9-3

This lot is close to the Estate entry and backs up to the public road outside of the complex. There is a ridge line going through the lot, which allows for a home to be sighted so that it will catch both the Sunrise and the Sunset. This is the only lot that can be entered from the public road, directly. Parking works best between the 140' and 150' contours. There are two logical access points; clearly the shortest and least intrusive access would be from the public road. On the other hand, for privacy and security purposes, access can come from below, directly behind the Estate entry. The driveway should be kept as narrow as possible and should not be visible from below. The home, ideally, would straddle the ridge and be between contours 125' and 140'. If it is decided that the access will be from the public road, a security gate will be required and only a pedestrian access to the Estate Road would be allowed.



-  The waters edge
-  Recommended parking location
-  Non-buildable area
-  Buildable area
-  Recommended home location
-  Recommended driveway access point
-  Cliff set-back